

LEVEL 5 FLOOR PLAN - SECTOR A1 2
1/4" = 1'-0"

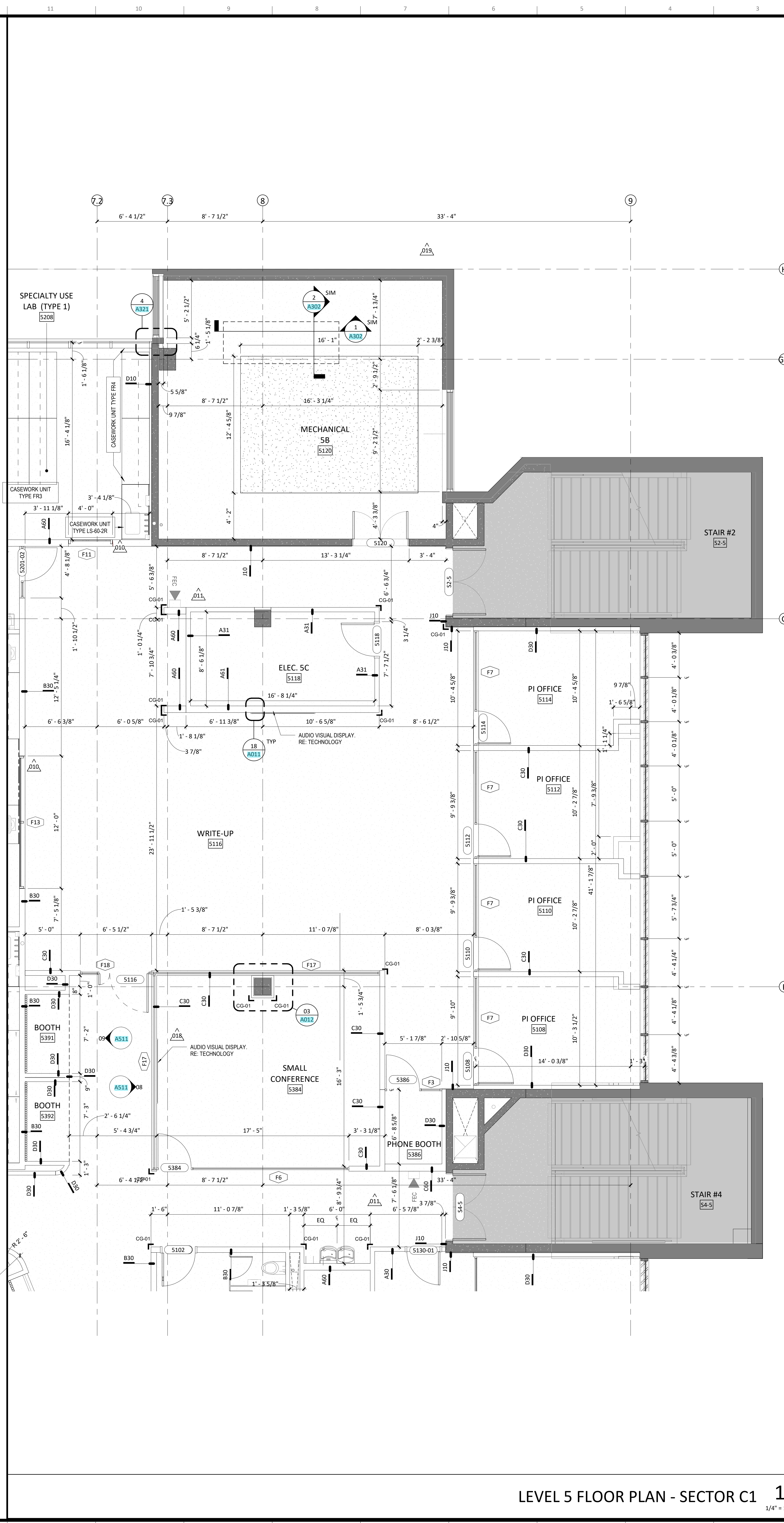

LEVEL 5 FLOOR PLAN - SECTOR C1 1
1/4" = 1'-0"

- General Notes (Floor Plans):
1. ALL WALL TYPES TO BE ADD UNLESS OTHERWISE NOTED.
 2. ALL WALL DIMENSIONS ARE TO FACE OF WALL UNLESS OTHERWISE NOTED.
 3. MASONRY WALLS ARE NOMINALLY CENTERED ON GRID LINES AND MASONRY DIMENSIONS ARE NOMINAL UNLESS OTHERWISE NOTED.
 4. DOORS IN STUD WALLS NEAR PERPENDICULAR WALLS ARE LOCATED 4" OFF FACE OF PERPENDICULAR WALL UNLESS OTHERWISE NOTED.
 5. DOORS IN MASONRY WALLS ARE LOCATED IN ROUGH OPENINGS DIMENSIONED ON SHEET.
 6. SEE GENERAL ACCESSIBILITY SHEET FOR HEIGHTS AND LOCATIONS OF WASHROOM ACCESSORIES.
 7. CONTRACTOR TO FIELD VERIFY ALL MEASUREMENTS AND CONDITIONS NEW AND EXISTING. NOTIFY THE ARCHITECT/OWNER'S REPRESENTATIVE OF ANY DISCREPANCIES.
 8. ENLARGED PLANS MAY BE ROTATED OR MIRRORRED; COORDINATE WITH OVERALL FLOOR PLAN.
 9. CONTRACTOR TO PROVIDE 4'-0" HIGH PLYWOOD BAKER BOARD IN ALL MECHANICAL AND ELECTRICAL ROOMS MOUNTED 3'-6" A.F.F. FOR PERIMETER OF ROOM.
 10. REFER TO SPECIFICATIONS MANUAL FOR EQUIPMENT LIST AND REQUIREMENTS.
 11. REFERENCE CODE COMPLIANCE PLANS FOR ELEMENTS REQUIRING INSTALLATION IN COMPLIANCE WITH ADA, INCLUDING BUT NOT LIMITED TO CASEWORK, PLUMBING AND EQUIPMENT.

owner:
State of Louisiana - Facility Planning and Control
1201 N. Third St., Suite 7-210
Baton Rouge, LA 70802
225.342.7000
www.dca.la.gov/isa/fpc/

architect:
Multistudio
3308 Magazine Street
New Orleans, LA 70115
504.488.8303
www.multistudio

Perkins Eastman
115 5th Ave.
New York, NY 10003
212.583.7200
www.perkinseastman.com

structural engineer:
Schmitt, Eddom & Flanagan Consulting Engineers,
4227 Bienville Avenue
New Orleans, LA 70113
504.482.7856
www.safengineers.com

MEP/FP + technology engineer:
TLC Engineering Solutions
201 St. Charles Ave., Suite 4318
New Orleans, LA 70170
504.777.0040
www.tlc-engineers.com

Issue Date: SEPTEMBER 05, 2025

NUMBER	DESCRIPTION	DATE
001	Part A - AGO 001	05/02/2024
010	Part B - AGO 010	07/08/2024
011	Part C - AGO 011	08/02/2024
018	Part D - AGO 018	12/27/2024
019	Part E - AGO 019	02/15/2025
024	Part F - AGO 024	09/05/2025

FOR
REFERENCE
ONLY

multistudio
the evolution of gould evans
+
PERKINS — EASTMAN

**LSU-HSC MEB
LABORATORY
RENOVATION**

1901 PERDIDO STREET
NEW ORLEANS, LA 70112

Project Number:
State of Louisiana - Facility Planning and Control
1201 N. Third St., Suite 7-210
Baton Rouge, LA 70802
225.342.7000
www.dca.la.gov/isa/fpc/

architect:
Multistudio
3308 Magazine Street
New Orleans, LA 70115
504.488.8303
www.multistudio

Perkins Eastman
115 5th Ave.
New York, NY 10003
212.583.7200
www.perkinseastman.com

structural engineer:
Schmitt, Eddom & Flanagan Consulting Engineers,
4227 Bienville Avenue
New Orleans, LA 70113
504.482.7856
www.safengineers.com

MEP/FP + technology engineer:
TLC Engineering Solutions
201 St. Charles Ave., Suite 4318
New Orleans, LA 70170
504.777.0040
www.tlc-engineers.com

Issue Date: SEPTEMBER 05, 2025

Revisions

NUMBER	DESCRIPTION	DATE
001	Part A - AGO 001	05/02/2024
010	Part B - AGO 010	07/08/2024
011	Part C - AGO 011	08/02/2024
018	Part D - AGO 018	12/27/2024
019	Part E - AGO 019	02/15/2025
024	Part F - AGO 024	09/05/2025

UNLESS A PROFESSIONAL SEAL WITH SIGNATURE AND DATE IS APPLIED, THIS DOCUMENT IS PRELIMINARY AND IS NOT INTENDED FOR CONSTRUCTION, RECORDING PURPOSES OR IMPLEMENTATION

MARTIN L. TOFFI
REGISTERED ARCHITECT
STATE OF LOUISIANA
1/12/24

**LEVEL 5 FLOOR PLAN -
SECTOR A1/C1
A105-1**

BID DOCUMENTS